



EN	Manual
DE	Handbuch
NL	Handleiding
FR	Manuel d'utilisation
IT	Manuale
SE	Manuell
ES	Manual
NO	Håndbok
DK	Håndbog
FI	Käsikirja
BG	Наръчник
SK	Príručka
HR	Priručnik
EE	Käsiraamat



EN | Assembly of the trolley



Parts

Bolt M6x30mm



x3

Nut M6



x3

Hex key



x1

Wrench

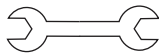

x1

Step 1. Attach the axle/wheels to the base part.

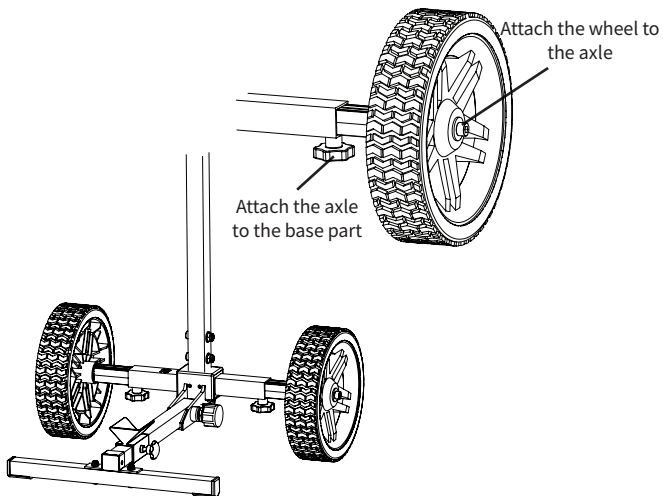

Step 2. Attach the horizontal support beam to the base part.

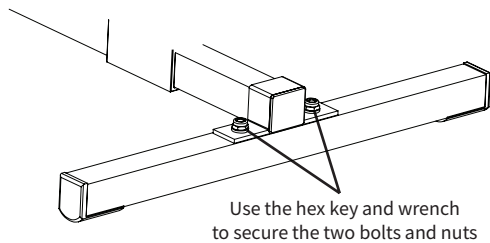

Step 3. Attach the bracket.

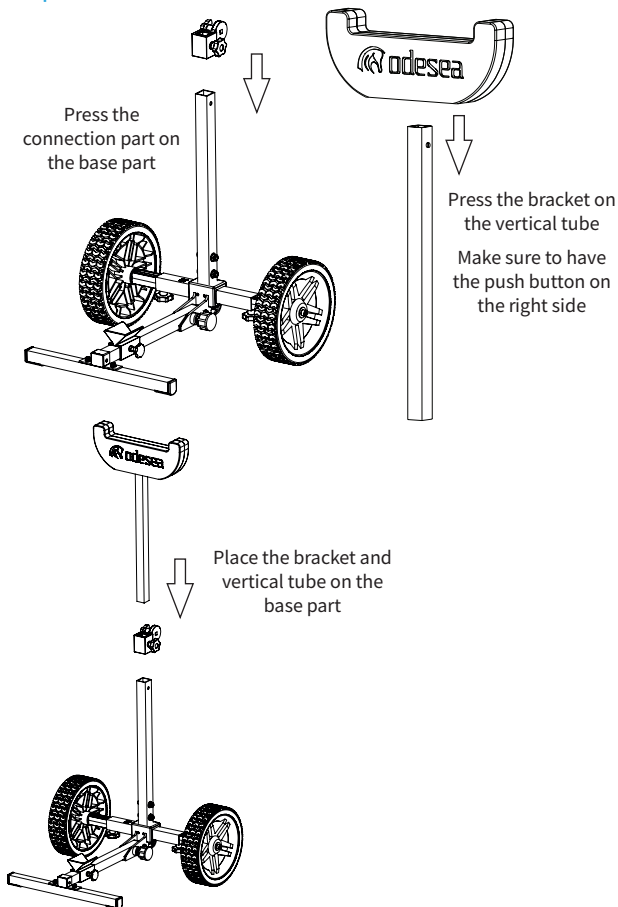

Step 4. Attach the handle.

Use the hex key to
secure the bolt and nut

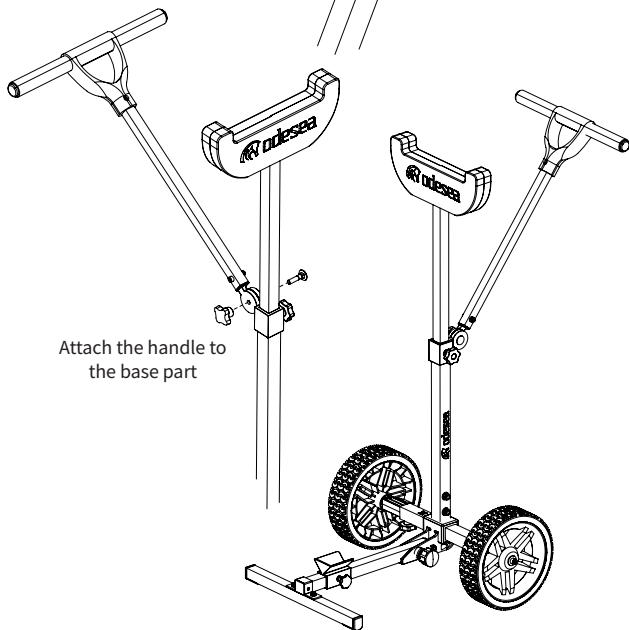
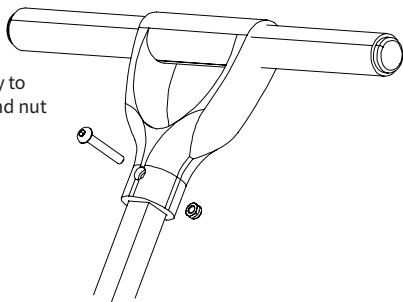

Attach the handle to
the base part

EN | Setting up the trolley

Step 1. Lower the trolley bracket to the lowest position.

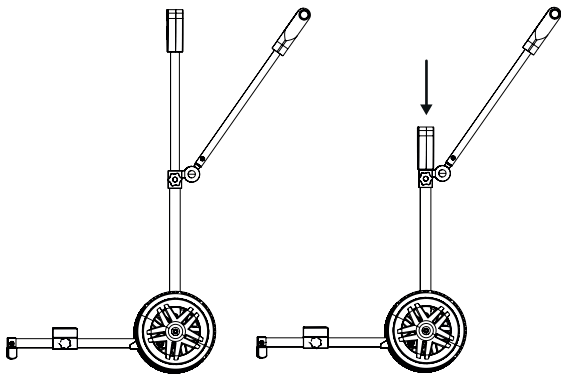

Step 2. Lock the engine in a straight position.

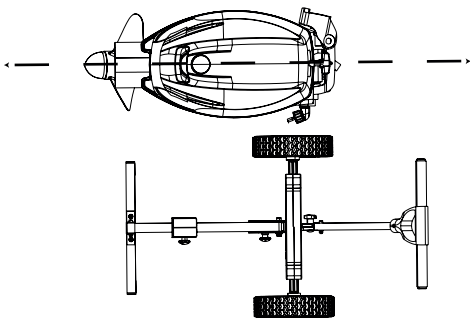

Step 3. Position the engine on the ground next to the trolley, with the back of the engine clamp parallel to the front of the trolley bracket.

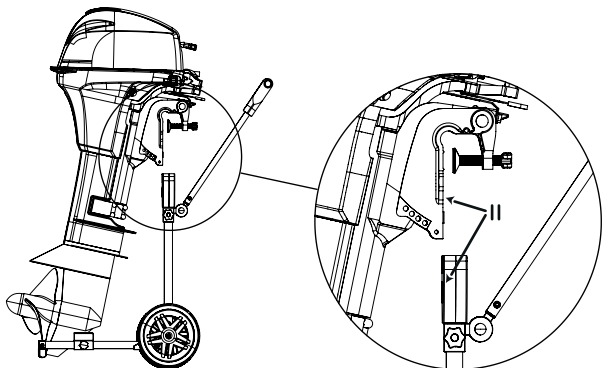

Step 4. Measure the horizontal distance between the bracket and the end of the engine tail.

Step 5. Slide the tail support to the previously measured position on the tube and tighten the knob.

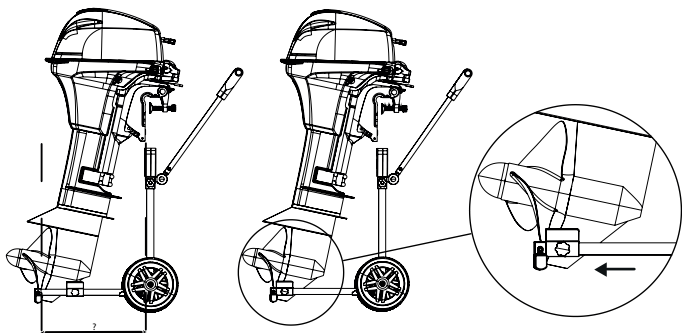

Now the trolley is set up for your engine. This does not need to be changed when you only use this specific engine on the trolley.

EN | Placing an engine on the trolley

WARNING! Read these instructions to ensure safe mounting of the outboard engine

Note: it is possible to use the outboard trolley as a single person.

The TX-65 outboard motor trolley is ready for mounting an outboard engine after being fully assembled and set up for your outboard engine. To mount an outboard engine onto the trolley, please read the following steps carefully.

Make sure that:

- the wheels are set to the maximum width and the knobs are turned tight
- the tube with the bracket is down so that the bracket rests on the frame
- the knob of the horizontal tube is tight

Step 1. Lift the outboard engine about 10 cm high and place the tail of the outboard engine in the tail-support. Use 2 hands!

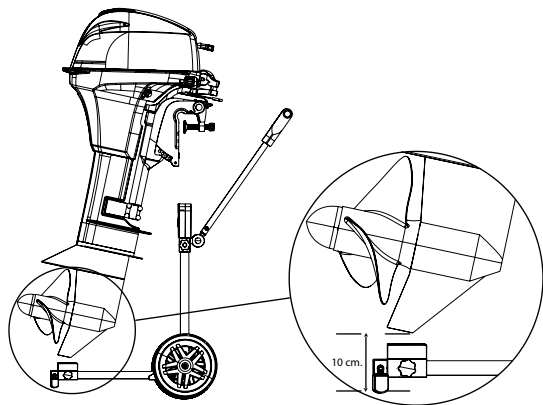

Step 2. Tilt the outboard engine so that it is straight above the bracket.

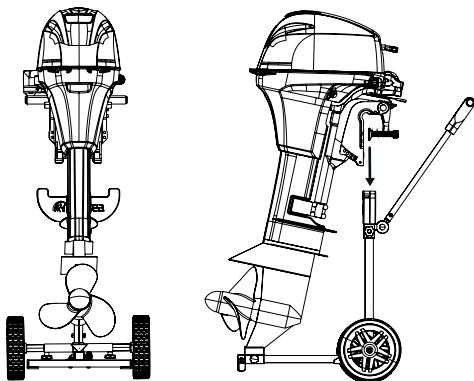

Step 3. Hold the engine with 1 hand. With the other hand lift the trolley bracket until it cannot go any higher.

Step 4. Tighten the knob of the tube with the bracket to fix it in position.

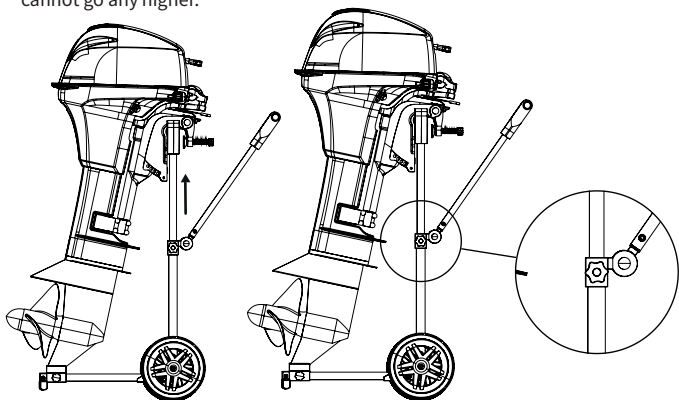

BG | Поставяне на двигател върху

ВНИМАНИЕ! Прочетете тези инструкции, за да осигурите безопасно монтиране на извънбордовия двигател

Забележка: възможно е да използвате извънбордовата количка като един човек.

За съвпадащи изображения вижте страници 7 и 8

Количката за извънбордов двигател TX-65 е готова за монтиране на извънбордов двигател, след като е напълно сглобени и настроени за вашия извънбордов двигател. За да монтирате извънбордов двигател на количката, моля, прочетете внимателно следните стъпки.

Уверете се, че:

- колелата са настроени на максимална ширина и копчетата са завъртени здраво
- тръбата със скобата е надолу, така че скобата да лежи върху рамката
- копчето на хоризонталната тръба е здраво

Стъпка 1. Повдигнете извънбордовия двигател на около 10 см височина и поставете опашката на извънбордовия двигател в опората за опашката. Използвайте 2 ръце!

Стъпка 2. Наклонете извънбордовия двигател, така че да е прав над скобата.

Стъпка 3. Дръжте двигателя с 1 ръка. С другата ръка повдигнете скобата на количката, докато не може да се издигне по-високо.

Стъпка 4. Затегнете копчето на тръбата със скобата, за да я фиксирате на място.



WWW.ODESEA.COM

